

## Verschleißkufen / Rear wear plates

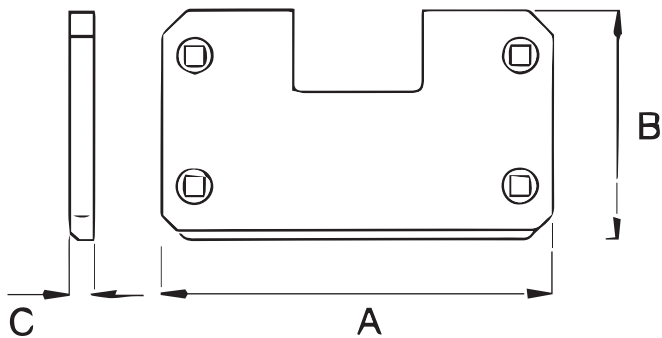

### Verschleißkufen

- Aus warmgewalztem, hochverschleißfestem Borstahl, gehärtet auf ca. 500 HB

### Rear wear plates

- Made of hot rolled Boron steel, hardened to approx. 500 HB

| Abmessungen (mm)<br>Dimensions (mm) |     |    |            | Gewicht<br>Weight<br>KG | Ref.-Nr.<br>Ref.-No. | Modell<br>Model | VeRotool-Bestell-Nr<br>VeRotool-No. |
|-------------------------------------|-----|----|------------|-------------------------|----------------------|-----------------|-------------------------------------|
| A                                   | B   | C  | Ø bolt (") |                         |                      |                 |                                     |
| 550                                 | 310 | 30 | 3/4        | 21,0                    | 11142033             | L90, L110, L120 | 600.11142033                        |
| 600                                 | 350 | 30 | 1          | 31,0                    | 11111811             | L150, L180      | 600.11111811                        |