

Verschleißkufen / Rear wear plates

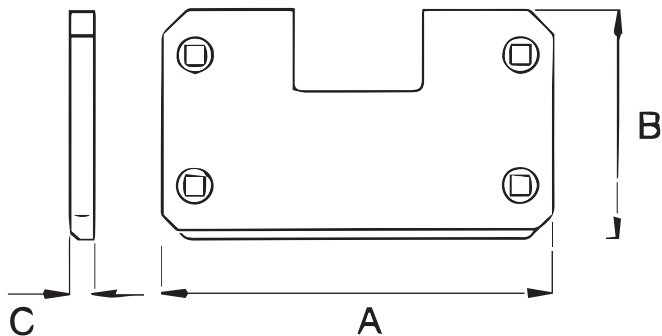

Verschleißkufen

- Aus warmgewalztem, hochverschleißfestem Borstahl, gehärtet auf ca. 500 HB

Rear wear plates

- Made of hot rolled Boron steel, hardened to approx. 500 HB

Abmessungen (mm) Dimensions (mm)				Gewicht Weight KG	Ref.-Nr. Ref.-No.	Modell Model	VeRotool-Bestell-Nr VeRotool-No.
A	B	C	Ø bolt (")				
527	250	25	3/4	21,0	9W6747	950G, 960F, 962G	600.9W6747
565	250	35	3/4	34,0	9W6749	966D/E/F, 970/F	600.9W6749
597	250	35	3/4	38,0	9W6750	980FII, 980M/K	600.9W6750
622	250	35	3/4	41,0	109-9215	980F/G	600.109-9215
565	250	35	3/4	37,0	161-8573	966G/K, 972G/K	600.161-8573
440	250	35	3/4	29,5	248-2419	950G, 962G, 966K	600.248-2419