

Verschleißkufen / Rear wear plates

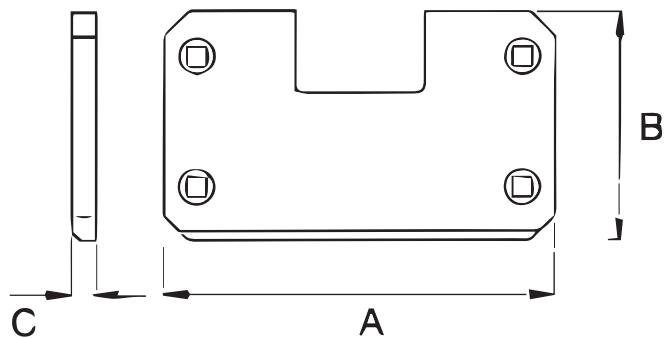

Verschleißkufen

- Aus warmgewalztem, hochverschleißfestem Borstahl, gehärtet auf ca. 500 HB

Rear wear plates

- Made of hot rolled Boron steel, hardened to approx. 500 HB

Abmessungen (mm) Dimensions (mm)				Gewicht Weight KG	Ref.-Nr. Ref.-No.	Modell Model	VeRotool-Bestell-Nr VeRotool-No.
A	B	C	Ø bolt (")				
360	225	30	7/8	15,0	419-73-H2540	WA320-6	600.419-73-H2540
500	280	30	7/8	24,9	421-72-H2G30	WA470-6, WA480-6	600.421-72-H2G30
420	200	45	7/8	23,5	423-76-H2720	WA380-6/7, WA430-6	600.423-76-H2720
540	350	25	7/8	31,4	425-71-H2A00	WA500-6/7	600.425-71-H2A00