

Schraubzähne / Bolt-on teeth

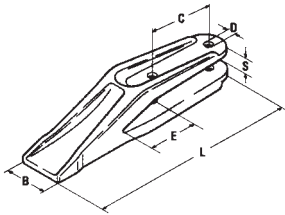

Gabelschraubzähne

- ◆ Aus hochverschleißfestem Stahl
- ◆ Geeignet für Schneiden von etwa 15 bis 40 mm
- ◆ Mit spitzem Schlitz

Fork Type Tooth

- ◆ Made of highly wear resistant steel
- ◆ Suitable for cutting edge of 15 – 40 mm
- ◆ Slot accepts chamfered edges

| Abmessungen (mm) Dimensions (mm) | | | | | | Gewicht Weight KG | Ref.-Nr. Ref.-No. | VeRotool-Bestell-Nummer VeRotool-No. | | |
|-------------------------------------|-----|----|-----|-----|----|-------------------------|-------------------------------------|---|----------------------|--------------------|
| B | C | D | E | L | S | | | Zahn Tooth | Schrauben* Bolts* | Anzahl Quantity |
| 40 | 60 | 17 | 45 | 235 | 17 | 2,5 | 20T-70-23130 Komatsu 8282253 O&K | 218 | 5/8" x 55 | 2 |
| 60 | 65 | 12 | 65 | 275 | 21 | 3,3 | | 209 | M 12 x 55 | 2 |
| 80 | 110 | 17 | 75 | 360 | 26 | 4,9 | 771956709 Hanomag | 201 | M 16 x 70 | 2 |
| 85 | 135 | 17 | 90 | 420 | 34 | 9,7 | 777956706 Hanomag | 202 | M 16 x 80 | 2 |
| 90 | 160 | 25 | 115 | 425 | 37 | 11,0 | 7759656706 Hanomag | 203 | M 24 x 100 | 2 |

* gehören nicht zum Lieferumfang

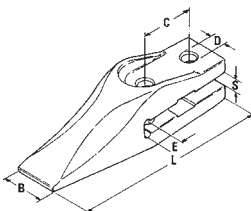

Gabelschraubzähne

- ◆ Aus hochverschleißfestem Stahl
- ◆ Geeignet für Schneiden von etwa 15 bis 40 mm
- ◆ Mit stumpfem Schlitz

Fork Type Tooth

- ◆ Made of highly wear resistant steel
- ◆ Suitable for cutting edge of 15 – 40 mm
- ◆ Slot accepts flat edges

| Abmessungen (mm) Dimensions (mm) | | | | | | Gewicht Weight KG | Ref.-Nr. Ref.-No. | VeRotool-Bestell-Nummer VeRotool-No. | | |
|-------------------------------------|----|----|----|-----|----|-------------------------|----------------------|---|----------------------|--------------------|
| B | C | D | E | L | S | | | Zahn Tooth | Schrauben* Bolts* | Anzahl Quantity |
| 39 | 55 | 17 | 35 | 210 | 17 | 2,0 | 68131-6691-2 Kubota | 217 | M 16 x 45 | 2 |

* gehören nicht zum Lieferumfang

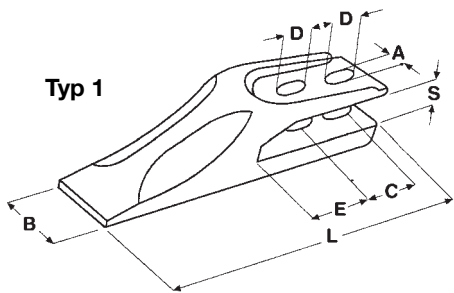

Typ 1

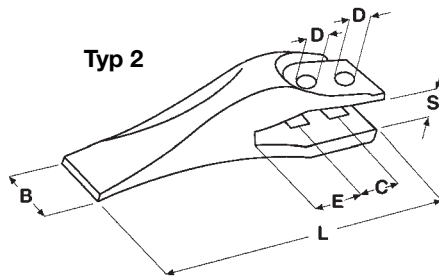

Typ 2

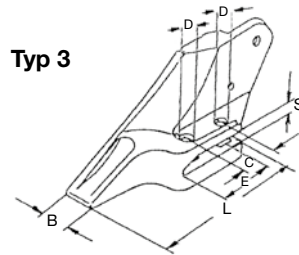

Typ 3

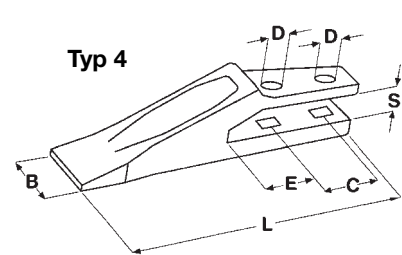

Typ 4

Gabelschraubzähne

- ◆ Aus hochverschleißfestem Stahl
- ◆ Geeignet für Schneiden von 15–21 mm
- ◆ Mit spitzem Schlitz

Fork Type Tooth

- ◆ Made of highly wear resistant steel
- ◆ Suitable for cutting edge of 15–21 mm
- ◆ Slot accepts chamfered edges

| Abmessungen (mm) Dimensions (mm) | | | | | | | Typ Type | Gewicht Weight KG | Ref.-Nr. Ref.-No. | VeRotool-Bestell-Nummer VeRotool-No. | | |
|-------------------------------------|----|-------|------|----|-----|----|-------------|-------------------------|----------------------|---|----------------------|--------------------|
| A | B | C | D | E | L | S | | | | Zahn Tooth | Schrauben* Bolts* | Anzahl Quantity |
| 13 | 42 | 40/45 | 18 | 36 | 185 | 17 | 1 | 1,2 | 6696, E12.4, SF100 | 204-2 | M 12 x 45 | 2 |
| | 50 | 45 | 20,5 | 55 | 250 | 22 | 2 | 2,3 | 53103205-JCB | R17031100 | 3/4" x 2 3/4" PB | 2 |
| | 50 | 45 | 20,5 | 55 | 280 | 22 | 3 | 2,6 | 53103208-JCB | R17031108 | 3/4" x 2 3/4" PB | 2 |
| | 50 | 45 | 20,5 | 55 | 280 | 22 | 3 | 2,6 | 53103209-JCB | R17031109 | 3/4" x 2 3/4" PB | 2 |
| | 50 | 75 | 20 | 50 | 280 | 22 | 4 | 2,6 | 6Y6335/9W1879-CAT | R17000100 | 5/8" x 2 1/2" PB | 2 |

* gehören nicht zum Lieferumfang

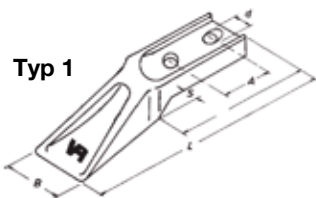

Typ 1

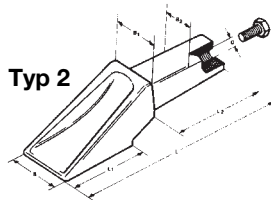

Typ 2

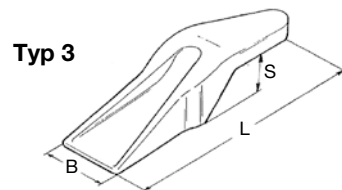

Typ 3

Anschraub- und Anschweißzähne

- ◆ Geeignet für Schneidmesser für etwa 15 bis 20 mm

Bolt-on monobloc teeth

- ◆ Suitable for cutting edges of 15 – 20 mm

| Typ Type | Abmessungen (mm) Dimensions (mm) | | | | | | | Gewicht Weight KG | Ref.-Nr. Ref.-No. | VeRotool-Bestell-Nummer VeRotool-No. | | |
|-------------|-------------------------------------|----|----|-----|-----|-----|----|-------------------------|----------------------|---|----------------------|--------------------|
| | A | B | C | D 1 | D 2 | L | S | | | Zahn Tooth | Schrauben* Bolts* | Anzahl Quantity |
| 1 | 40/45 | 50 | 40 | 13 | 13 | 180 | 15 | 1,1 | 5902647350 Schaeff | 91-2 | M 12 x 40 SI | 2 |
| 1 | 55/60 | 60 | 43 | 17 | 17 | 210 | 20 | 1,5 | 5902647360 Schaeff | 94-2 | M 16 x 45 SI | 2 |
| 2 | — | 60 | 27 | 15 | 15 | 220 | 20 | 1,5 | 830899 Atlas | 101 | incl. | — |
| 3 | — | 50 | — | — | — | 180 | 16 | 0,9 | 6638 | 6638.214 | — | — |

*gehören nicht zum Lieferumfang

Greiferzähne / Clam shell teeth

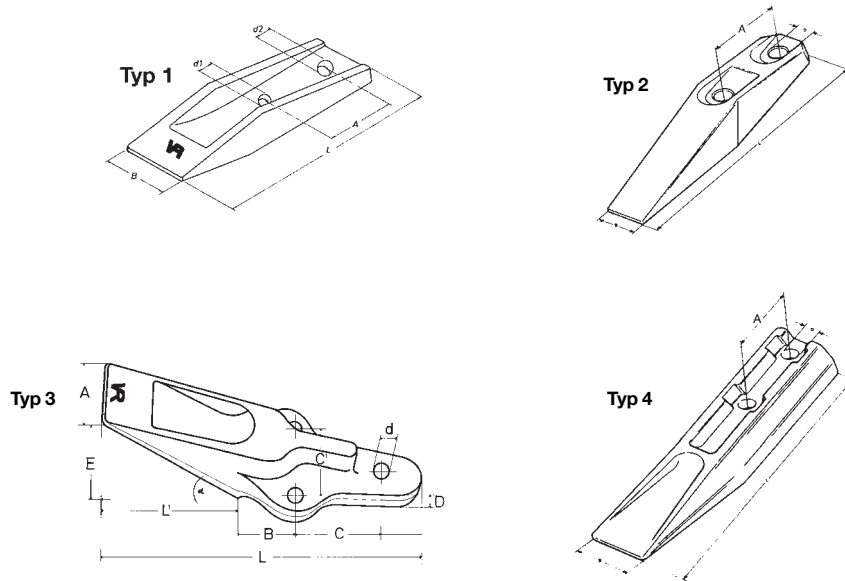

| Typ Type | Abmessungen (mm) Dimensions (mm) | | | | | Gewicht Weight KG | Ref.-Nr. Ref.-No. | VeRotool-Bestell-Nummer VeRotool-No. | | |
|-------------|-------------------------------------|----|----------------|----------------|-----|-------------------------|-----------------------|---|------------------------|--------------------|
| | A | B | D ₁ | D ₂ | L | | | Zahn Tooth | Schrauben* Bolts* | Anzahl Quantity |
| 1 | 68 | 62 | 17 | 17 | 175 | 1,2 | 640002086 | 8656.210 | M 16 x 45 SI | 2 |
| 1 | 68 | 62 | 16 | 18 | 209 | 1,5 | 6383324056 | 8657.210 | M 16 x 45 SI | 2 |
| 1 | 85 | 62 | 17 | 17 | 209 | 1,5 | 640000050 | 8657.216 | M 16 x 45 SI | 2 |
| 2 | 100 | 50 | 25 | 26 | 315 | 4,9 | 1146761 - 33016 | 80 | M 24 x 70 + 24 x 80 SK | je 1 |
| 2 | 110 | 60 | 25 | 26 | 405 | 7,5 | 307000287 - 300260021 | 81 | M 24 x 90 + 24 x 80 SK | je 1 |
| 4 | 90 | 75 | 24 | 24 | 328 | 5,5 | 456113 | 200 | M 24 x 80 SK | 2 |

*gehören nicht zum Lieferumfang

| Typ Type | Abmessungen (mm) Dimensions (mm) | | | | | | | | | | Gewicht Weight KG | Ref.-Nr. Ref.-No. | VeRotool-Bestell-Nr. VeRotool-No. | |
|-------------|-------------------------------------|----|-----|----|----|----|-----|-----|-----|----|-------------------------|----------------------|--------------------------------------|--|
| | A | B | C | C1 | D | E | L | L1 | a | d | | | Zahn Tooth | |
| 3 | 68 | 40 | 78 | 60 | 16 | 53 | 265 | 126 | 21° | 21 | 3,0 | 1153904 Atlas | 6586.70-1 | |
| 3 | 65 | 40 | 78 | 60 | 16 | 53 | 280 | 122 | 21° | 17 | 3,0 | 0829589 Atlas | 6586.70 | |
| 3 | 75 | 65 | 90 | 70 | 20 | 61 | 328 | 125 | 24° | 21 | 5,3 | 1218797 Atlas | 6587.72 | |
| 3 | 75 | 40 | 140 | 80 | 20 | 61 | 328 | 125 | 24° | 18 | 5,3 | 9169430 Liebherr | 6587.73 | |
| 3 | 75 | 40 | 140 | 80 | 20 | 61 | 328 | 125 | 24° | 21 | 5,3 | | 6587.73-1 | |