

Unterschraubmesser / Bolt-on cutting edges

- ◆ Aus warmgewalztem, hochverschleißfestem Borstahl, gehärtet auf ca. 500 Brinell

- ◆ Made of hot rolled Boron steel, hardened to appr. 500 Brinell

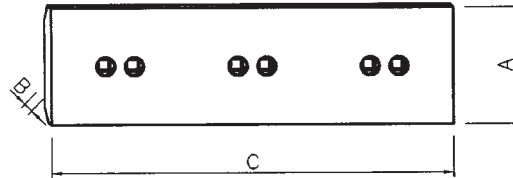
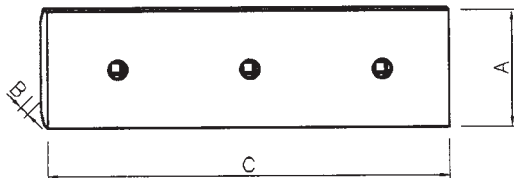

Ref.-Nr. Ref.-No.	VeRotool-Bestell-Nr. VeRotool-No.	Gewicht Weight	Abmessungen (mm) Dimensions (mm)				Model Model
			A (mm)	B (mm)	C (mm)	Ø Bolt (")	
1U0295	600.1U0295	50,9	280	25	1025	1	916, 926, 953
1U0593	600.1U0593	111,0	360	30	1319	1 ¼	966D,966E
1U0601	600.1U0601	81,8	360	30	1210	1	950B, 950E,966D
1U0605	600.1U0605	42,3	280	25	851	1	941, 951B,951C
1U0607	600.1U607	51,9	280	25	1044	1	920, 930
1U0761	600.1U0761	43,5	265	40	556	1 ¼	980C
1U0762	600.1U0762	149,6	406	35	1406	1 ¼	980C
1U1464	600.1U1464	40,7	280	25	819	1	920, 930,950
1U1465	600.1U1465	39,1	280	25	788	1	920,930, 950
1U1470	600.1U1470	74,5	360	30	990	1	950
1U1471	600.1U1471	84,4	360	30	1120	1	950
1U1476	600.1U1476	110,5	360	30	1404	1	966A,966B,966C
1U1909	600.1U1909	95,6	360	30	1260	1 ¼	966D, 966E
1U2406	600.1U2406	96,9	360	30	1231	1 ¼	966C
1U2407	600.1U2407	96,3	360	30	1223	1 ¼	966C
1U2408	600.1U2408	80,1	360	30	1018	1 ¼	977L
1U2409	600.1U2409	96,9	360	30	1205	1 ¼	977L
1U2412	600.1U2412	90,4	360	30	1148	1"	950
100-6668	600.100-6668	112	360	30	1398	1 ¼	966G, 970G, 972G
110-4711	600.110-4711	56	280	25	1200	1	938G
132-4724	600.132-4724	38	165	16	1890	M16SI	906M, 908M
139-9320	600.139-9320	105	360	30	1282	1	950G, 962G
4T2913	600.4T2913	48	250	20	1308	¾	910
4T2914	600.4T2914	15	250	20	433	¾	910
4T6588	600.4T6588	126	406	35	1211	1	988B
9W1375	600.9W1375	162,2	406	35	1524	1 ¼	988B

- Weitere Unterschraubmesser auf Anfrage
- Further bolt-on edges on request

Eckmesser für Eckenschutzsegment / Corner edges for corner guard system

◆ Aus warmgewalztem, hochverschleißfestem Borstahl, gehärtet auf ca. 500 Brinell

◆ Made of hot rolled Boron steel, hardened to appr. 500 Brinell

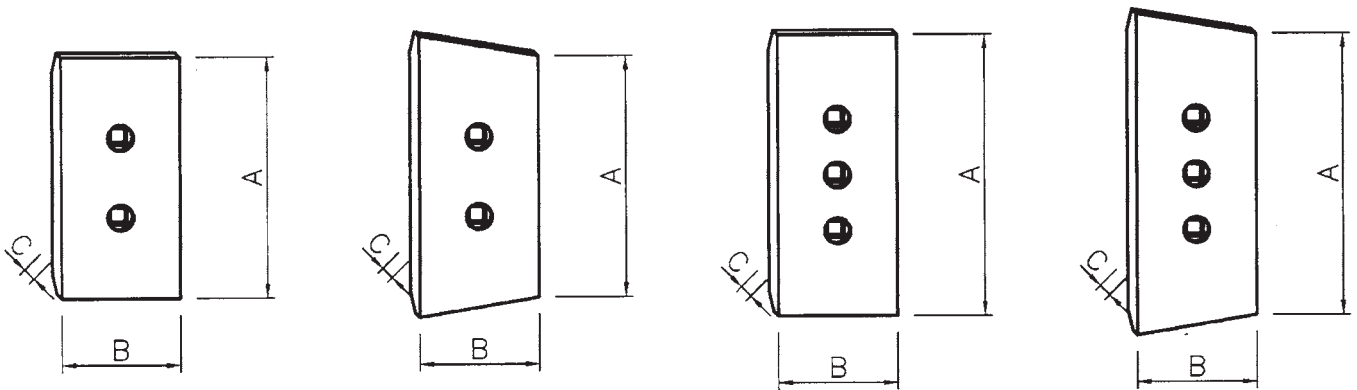

Ref.-Nr. Ref.-No.	VeRotool-Bestell-Nummer VeRotool-No.	Gewicht Weight	Abmessungen (mm) Dimensions (mm)				Modell Model
			A (mm)	B (mm)	C (mm)	ø Bolt (")	
1U0761	600.1U0761	43,5	556	264	40	1 1/4	988F, 980F, 988B, 980C
3G6395	600.3G6395	25,6	510	200	35	1 1/4	977, 973, 970F, 966D, 966E, 966G, 966C, 972G
4T8091	600.4T8091	9,5	342	160	25	1	953, 951, 943 941, 936, 930 926, 920, 916, IT28
4T8101	600.4T8101	17,5	496	175	30	1	963, 955, 950 950B, 950E, G
106-9290	600.106-9290	29,0	510	230	35	1 1/4	977, 973, 970F, 966D 966E, 966F, 966C

Segmente / Segments

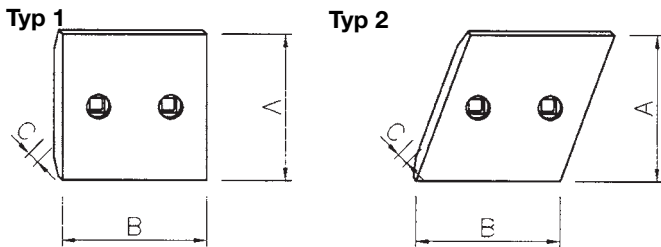

◆ Aus warmgewalztem, hochverschleißfestem Borstahl, gehärtet auf ca. 500 Brinell

◆ Made of hot rolled Boron steel, hardened to appr. 500 Brinell

Typ Type	Ref.-Nr. Ref.-No.	VeRotool-Bestell-Nr. VeRotool-No.	Gewicht Weight	Abmessungen (mm) Dimensions (mm)				Model Model
				A (mm)	B (mm)	C (mm)	Ø Bolt (")	
1	4T6695	600.4T6695	12,9	280	265	25	1	IT28, IT18, IT12 936E/F, 950B/E/F
1	4T6698	600.4T6698	19,0	360	240	30	1 ¼	966D/E/F, 973
1	4T6699	600.4T6699	20,4	360	270	30	1 ¼	966D/E/F, 973
2	9W5730	600.9W5730	38,8	483	323	35	1 ¼	980F/G, 988B/F
1	9W5734	600.9W5734	38,2	483	312	35	1 ¼	980F/G, 988B/F
2	9W5737	600.9W5737	38,8	483	323	35	1 ¼	980F/G, 988B/F
1	100-6666	600.100-6666	21,2	360	293	30	1 ¼	960, 966K, 970, 972G/H/K
1	140-6862	600.140-6862	24,0	360	256	35	1 ¼	982
2	140-6863	600.140-6863	23,1	360	265	35	1 ¼	966H/K
2	140-6864	600.140-6864	23,1	360	265	35	1 ¼	966H/K

- Weitere Unterschraubmesser auf Anfrage
- Further bolt-on edges on request

Verschleißkufen / Rear wear plates

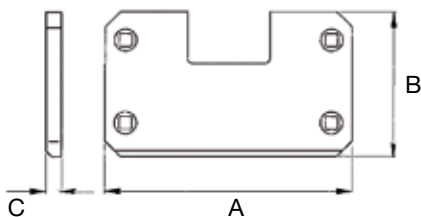

◆ Aus warmgewalztem, hochverschleißfestem Borstahl, gehärtet auf ca. 500 Brinell

◆ Made of hot rolled Boron steel, hardened to appr. 500 Brinell

Ref.-Nr. Ref.-No.	VeRotool-Bestell-Nr. VeRotool-No.	Gewicht Weight	Abmessungen (mm) Dimensions (mm)				Model Model
			A (mm)	B (mm)	C (mm)	Ø Bolt (")	
9W6747	600.9W6747	35,0	527	250	25	3/4	950G, 960F, 962G
9W6749	600.9W6749	38,0	565	250	35	3/4	966D/E/F, 970/F
109-9215	600.109-9215	41,0	622	250	35	3/4	980F/G
161-8573	600.161-8573	37,0	565	250	35	3/4	966G/K, 972G/K
248-2419	600.248-2419	29,5	440	250	35	3/4	950G, 962G, 966K

Halbpfeil-Unterschraubsegmente / bolt-on half-arrow segments

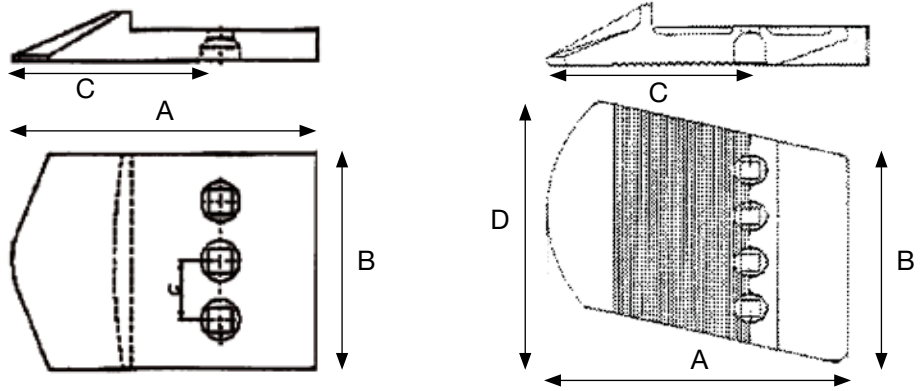

- ◆ Aus hochverschleißfestem Stahl, gehärtet auf ca. 500 HB
- ◆ Verbessern die Eindringung in das Material besonders bei großen Radladern
- ◆ Schützen das Basismesser vor Verschleiß
- ◆ Made of highly wear resistant steel; hardened to approx. 500 HB
- ◆ Facilitate the penetration into the material especially on large wheel loaders
- ◆ Protecting the base edge against wear

Ref.-Nr. Ref.-No.	VeRotool-Bestell-Nr. VeRotool-No.	Gewicht Weight KG	Abmessungen (mm) Dimensions (mm)				Bohr Holes	Messer- winkel° Spade angle°	Model Model
			A)	B (mm)	C (mm)	D (mm)			
109-9080 CTR	600.109-9080	46	420	275	342	-	3	-	988F/G
109-9081 RH	600.109-9081	44	420	275	342	442	3	15	988F/G
109-9082 LH	600.109-9082	44	420	275	342	442	3	15	988F/G